

Open Data and the University

Presentation at
Governance and Appeals Committee
of the University of Prince Edward Island Board of Governors

by Peter Rukavina, Hacker in Residence, Robertson Library

September 6, 2016



<http://hacker.vre.upei.ca/>

Open data is machine-readable data about and from the enterprise, provided in known, well-documented, digital formats, without restriction, to the general public.

An Open Data Case Study

“Where Does PEI’s Electricity Come From?”



[Windmill](#) by [Stephen Downes](#) is licensed under [CC BY-NC 2.0](#)



[Photo of Richard Brown from Liberal Party of Prince Edward Island](#)



Photo of [Ron Estabrooks](#) taken at the open house to officially launch the Hermanville/Clearspring wind development from www.gov.pe.ca.

System Information

		Net Scheduled Interchange				
NB Load	NB Demand	ISO-NE	NMISA	QUEBEC	NOVA SCOTIA	PEI
1331	1361	389	-31	-436	73	122

Note: For actual and scheduled columns, positive values are exports and negative values are imports.

[Transmission Outages](#)

Jun 21, 2015 11:26:54 Atlantic Time. Times at which values are sampled may vary by as much as 5 minutes.

This page will automatically refresh itself every 5 minutes.

```
<!-- data -->
```

```
<table border="1" width="100%" cellpadding="2" cellspacing="0" bordercolor="#191970">
<tr>
  <td valign="top"><b>&nbsp;</b></td>
  <td valign="top"><b>&nbsp;</b></td>
  <td valign="top" colspan = 7><b>Net Scheduled Interchange&nbsp;</b></td>
</tr>
<tr>
  <td valign="top"><b>NB Load&nbsp;</b></td>
  <td valign="top"><b>NB Demand&nbsp;</b></td>
  <td valign="top"><b>ISO-NE&nbsp;</b></td>
  <td valign="top"><b>NMISA&nbsp;</b></td>
  <td valign="top"><b>QUEBEC&nbsp;</b></td>
  <td valign="top"><b>NOVA SCOTIA&nbsp;</b></td>
  <td valign="top"><b>PEI&nbsp;</b></td>
</tr>
<tr>
  <td nowrap bgcolor="" align="center">1326</td>
  <td nowrap bgcolor="" align="center">1355</td>
  <td nowrap bgcolor="" align="center">389</td>
  <td nowrap bgcolor="" align="center">-31</td>
  <td nowrap bgcolor="" align="center">-436</td>
  <td nowrap bgcolor="" align="center">73</td>
  <td nowrap bgcolor="" align="center">122</td>
</tr>
```

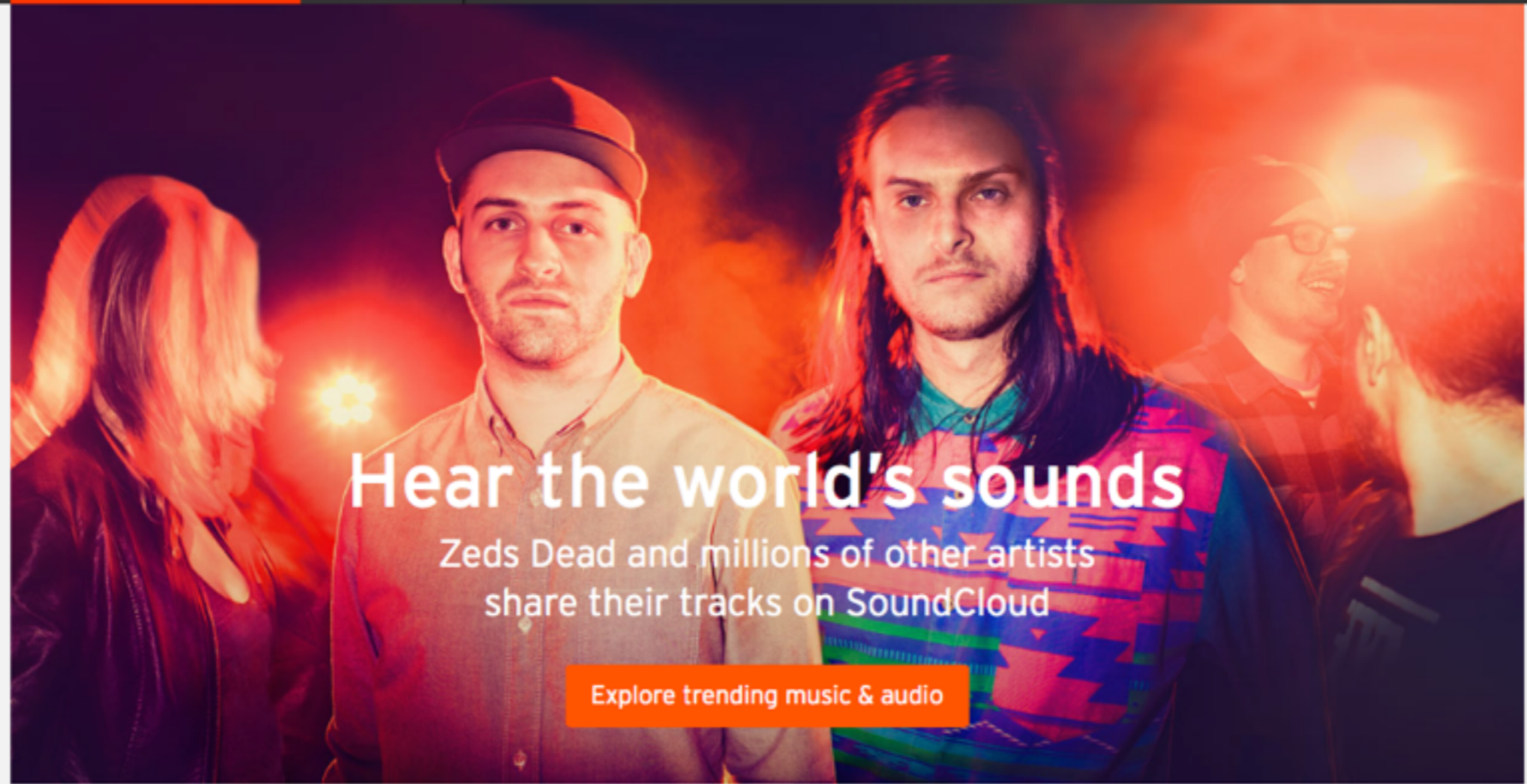
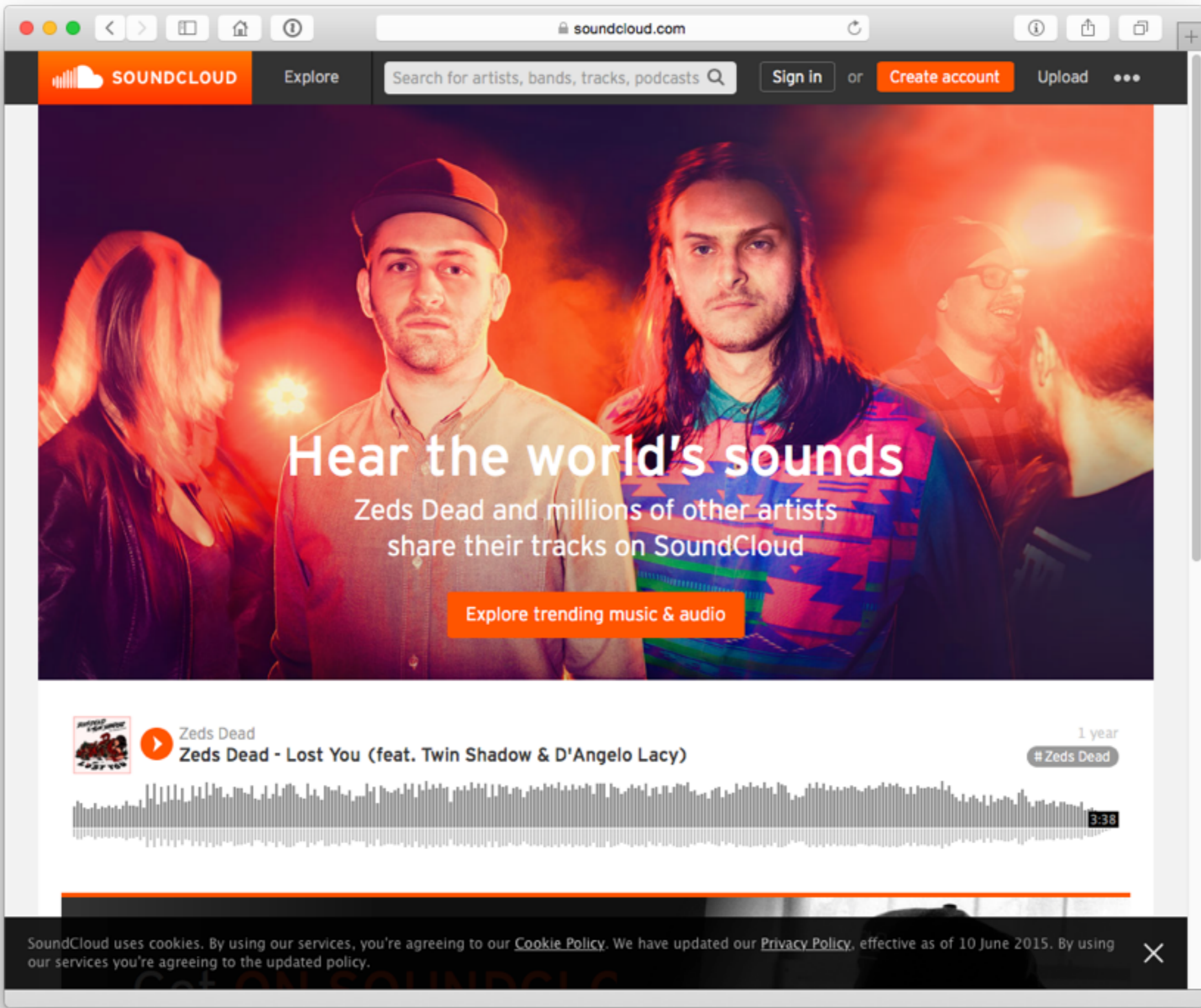
Hear the world's sounds

Zeds Dead and millions of other artists share their tracks on SoundCloud

Explore trending music & audio



Zeds Dead
Zeds Dead - Lost You (feat. Twin Shadow & D'Angelo Lacy)

1 year

Zeds Dead



3:38



50 BPM
50 MW

122 BPM
122 MW



Spark

with Nora Young

EPISODES

ABOUT

CONTACT



Have you ever looked at the flow of electricity between New Brunswick and PEI and thought, "Wow, I wonder if I could turn that into music?" Yeah, us either. But Peter Rukavina did. With some technical skill and a few free web services, Peter was able to turn somewhat dull information about inter-province electricity flow into a novel and compelling mashup. (Runs 8:50)

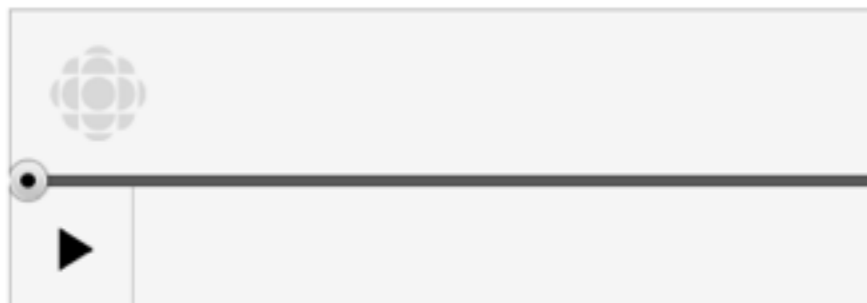

- [Peter Rukavina](#)
- [Peter's blog post Hear the Energy Flow: Pachube + SoundCloud Mashup](#)
- [Peter's electricity mashup \(will work in Google Chrome or Safari only\)](#)
- [Full uncut version of interview with Peter Rukavina](#)
- [Peter's annotated bootleg interview on SoundCloud](#)
- [SoundCloud track "Stand still" by weathercast](#)



Department Directory

Hermanville/Clearspring Wind Development

Wind Energy

North Cape Wind Farm

Eastern Kings Wind Farm Project

PEI Wind-Hydrogen Village

PEI Energy Accord

Renewable Energy

Oil and Gas Exploration

Energy

[HOME /](#)

SHARE

Prince Edward Island: World Leader in Wind Power Development

Since Prince Edward Island introduced its [Island Wind Energy strategy](#) in 2008, the province has become a world leader in wind power development.

PEI has a total peak electrical load of over 240 MW and the Island's seven wind facilities have a combined generating capacity of 203 MW

The five gauges presented below represent the total PEI electrical load, total on-Island generation (both wind and fossil fueled), and the breakdown of how much wind energy is used locally and how much is exported off-Island.

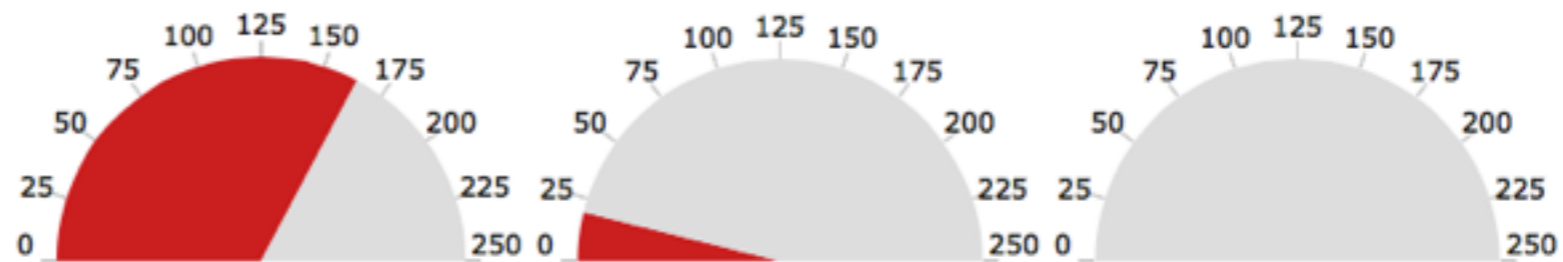

[Total On-Island Load](#)

[Total On-Island Wind Generated](#)

11.68% of full load

[Total On-Island Fossil Fueled Generation](#)

0% of full load

```
[
  {
    "data1":164.2,
    "data2":17.63,
    "data3":0,
    "updateDate":1437139741,
    "error":0
  }
]
```

```
[  
  {  
    "on-island-load": 164.2,  
    "on-island-wind": 17.63,  
    "on-island-fossil": 0,  
    "updateDate": 1437139741,  
    "error": 0  
  }  
]
```

update time	on-island-load	on-island-wind	on-island-fossil
2015-07-17 10:29:01	164.20	17.63	0.00
2015-07-17 10:14:01	163.09	19.05	0.00
2015-07-17 09:59:02	162.71	15.54	0.00
2015-07-17 09:44:02	162.33	12.79	0.00
2015-07-17 09:29:02	160.89	16.56	0.00
2015-07-17 09:14:02	160.16	17.95	0.00
2015-07-17 08:59:01	158.73	17.50	0.00
2015-07-17 08:44:01	156.78	15.17	0.00
2015-07-17 08:29:02	155.19	17.12	0.00
2015-07-17 08:14:02	151.82	11.82	0.00
2015-07-17 07:59:02	149.76	7.67	0.00
2015-07-17 07:44:01	146.21	9.17	0.00
2015-07-17 07:29:01	143.10	10.81	0.00
2015-07-17 07:14:02	139.31	13.76	0.00
2015-07-17 06:59:01	135.25	14.31	0.00
2015-07-17 06:44:01	129.52	12.55	0.00
2015-07-17 06:29:02	124.31	14.91	0.00

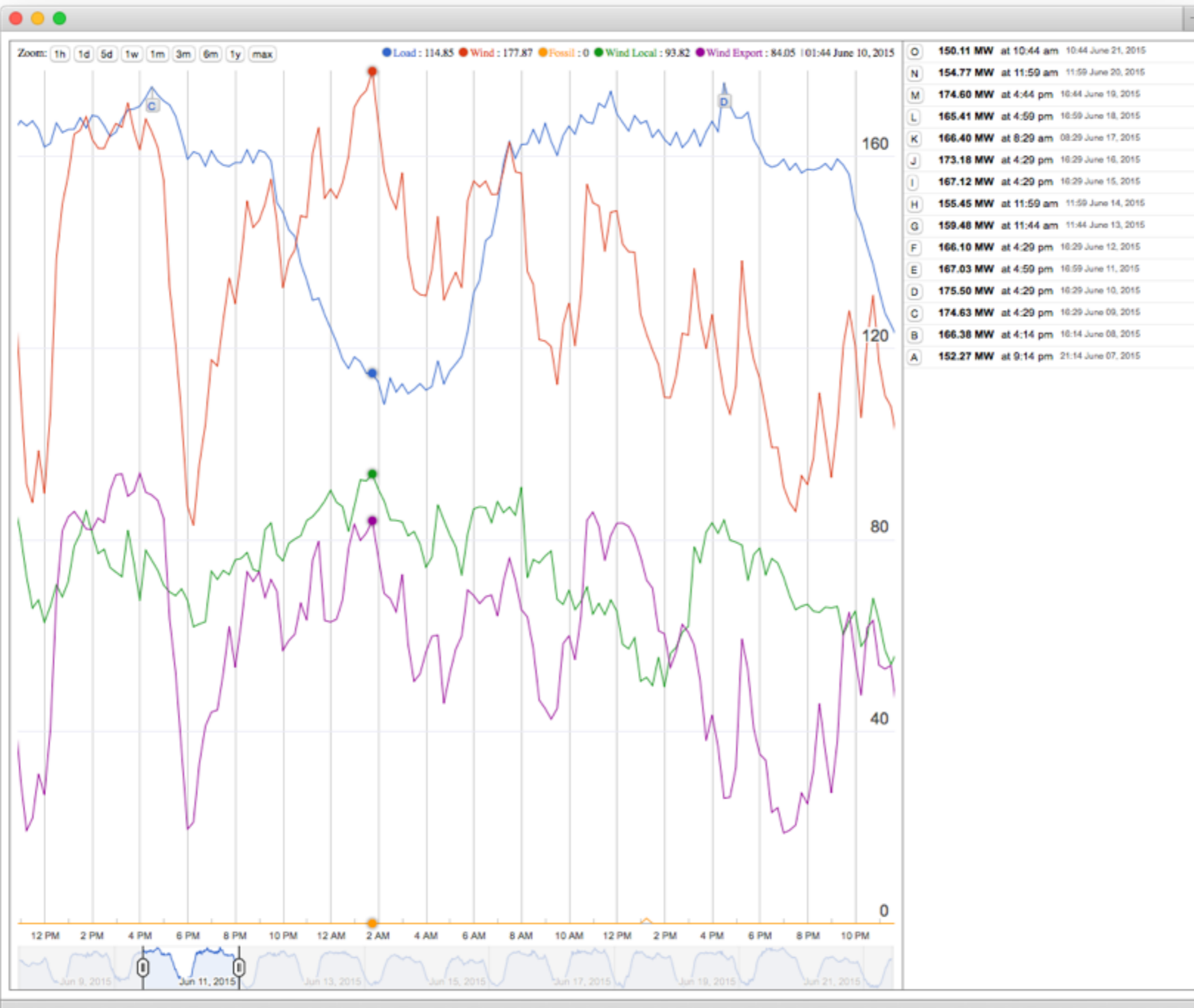

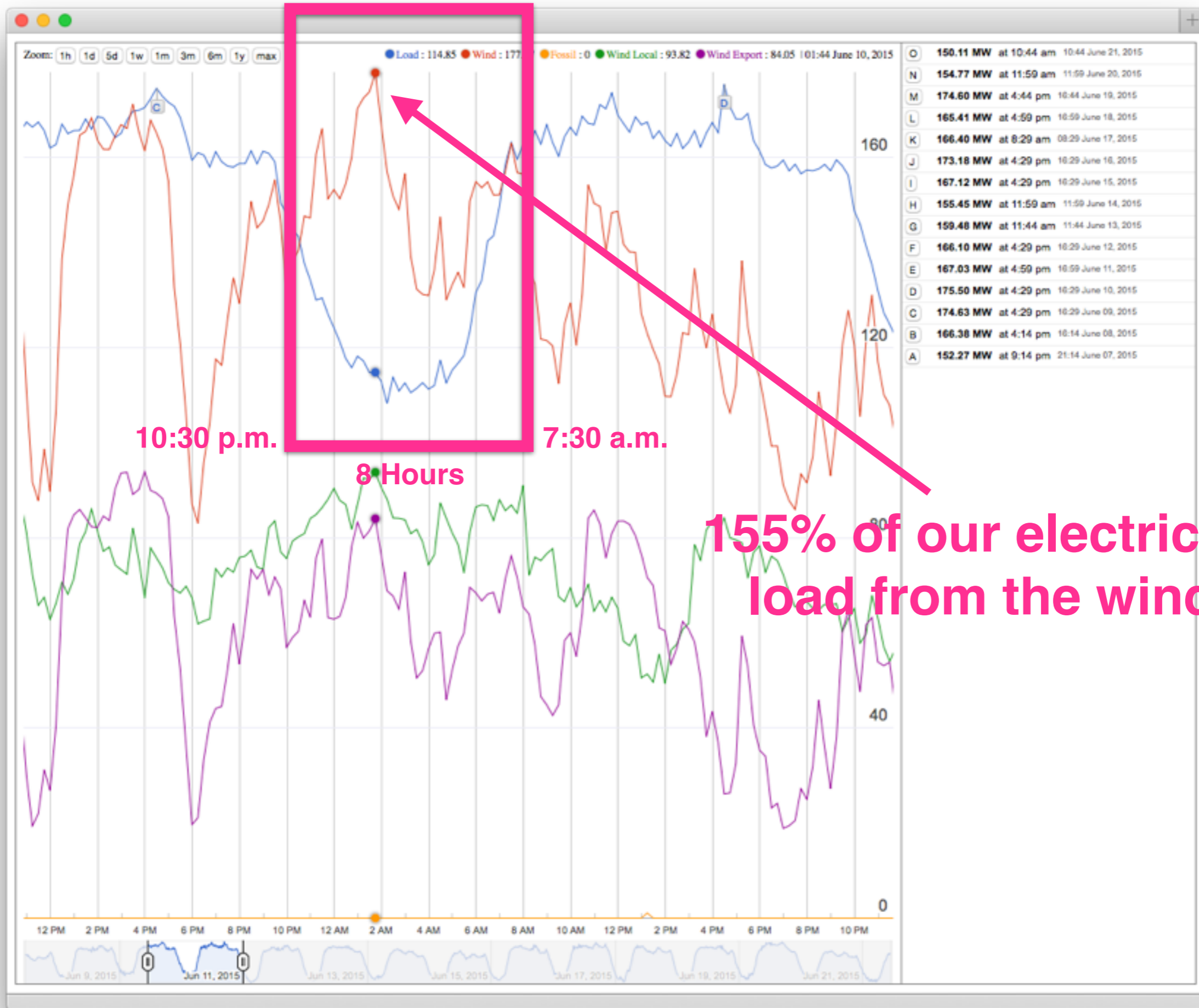

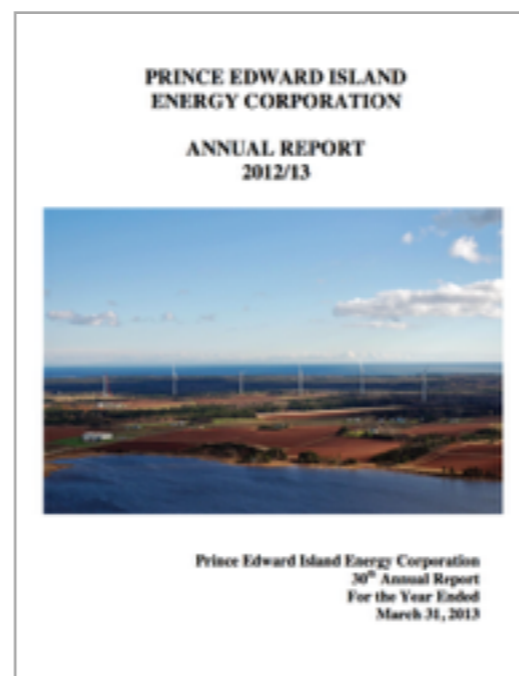

Executive Summary

The Prince Edward Island Energy Corporation is a provincial Crown corporation whose form and function is dictated by the (PEI) *Energy Corporation Act*. Through ownership of wind farms at North Cape (10.56 MW) and East Point (30 MW), the Corporation supplies approximately 121,500,000 kilowatt-hours of renewable electricity to Islanders. The Corporation provides an advisory service to government on energy matters that result in the formulation of policy, programs and legislation. Within its mandate, the Corporation also provides financing and support to other energy projects in PEI.

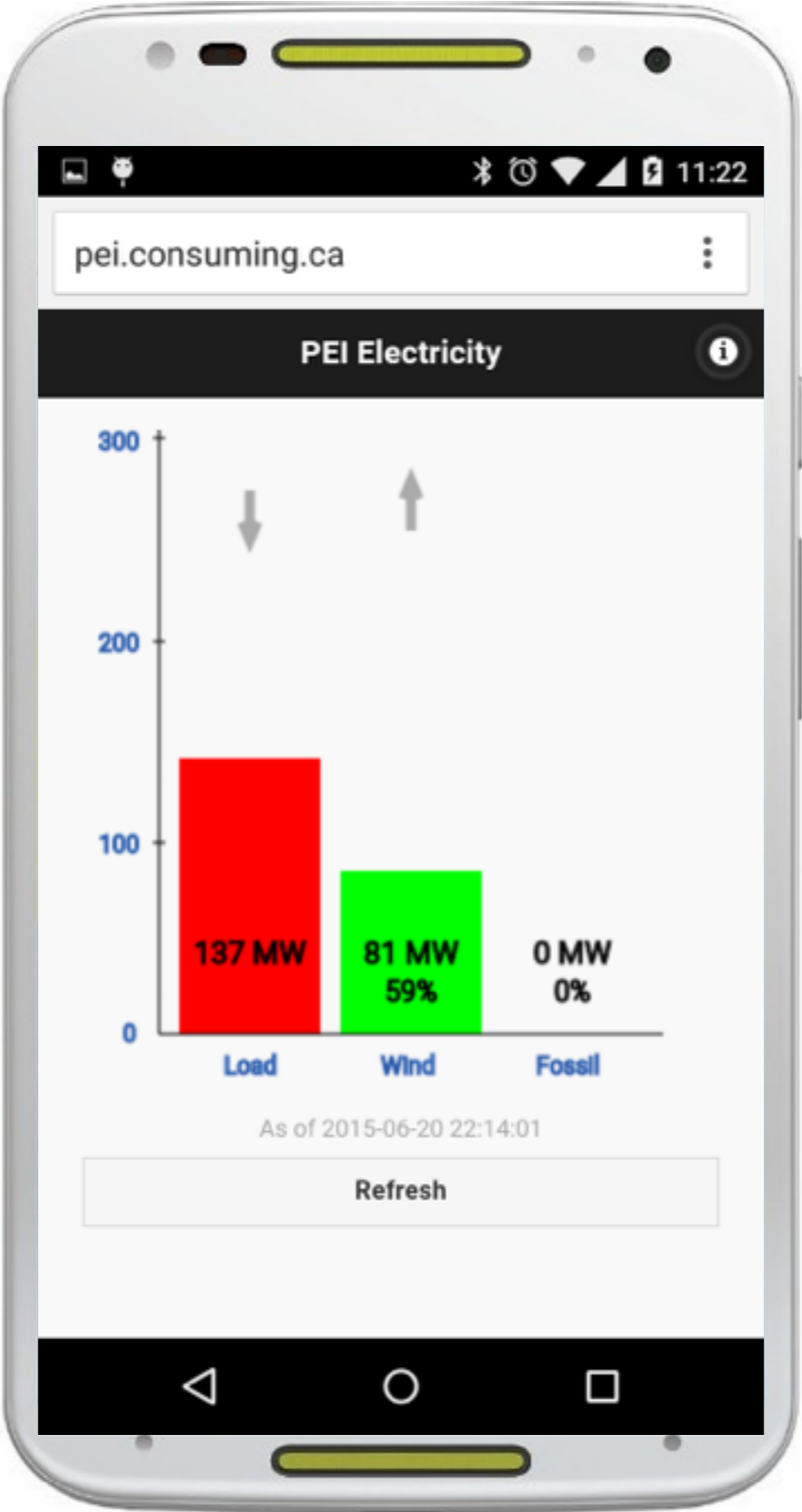





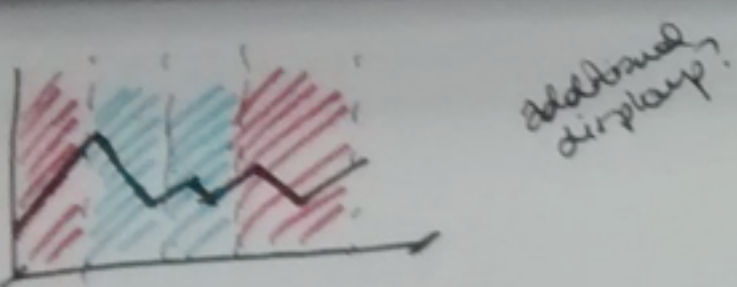

surfing the wave of the wind

difference between wind capacity & usage
 not red/green

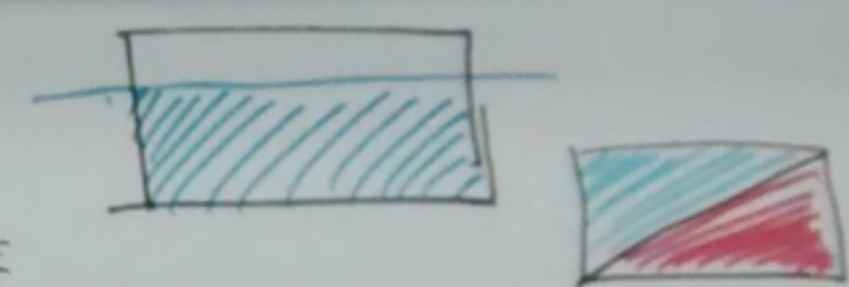

TIME
 WEATHER
 NEWS?
 ENERGY PROD. BY WIND

what is the sweet spot?
 (power goals?)

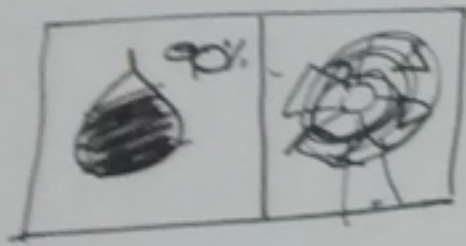

time & temp
 as compelling
 reason to
~~WATER~~

analysis vs. detail?

NEXT
 → Data gathering
 → Relationships w/ air, water, soil

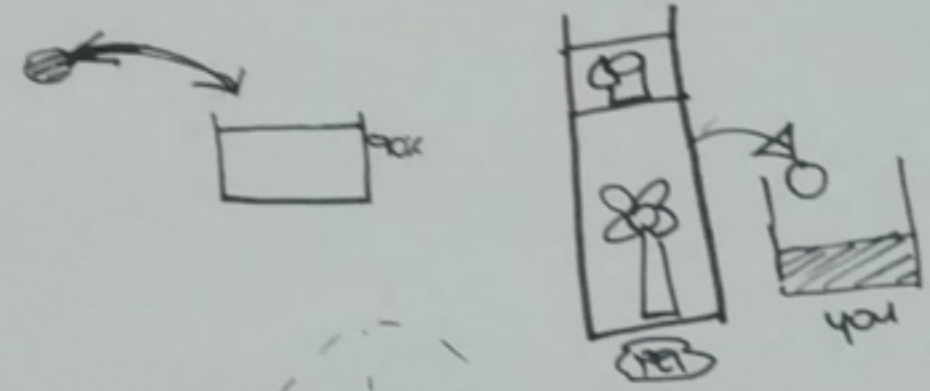

timings
 reduction

effort?

household v. business?

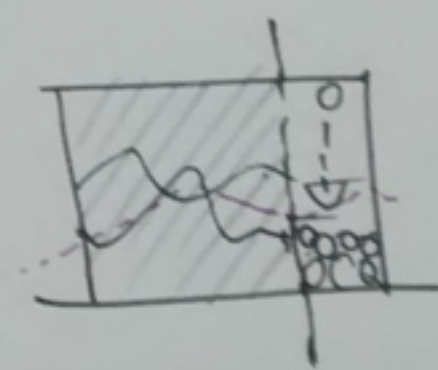
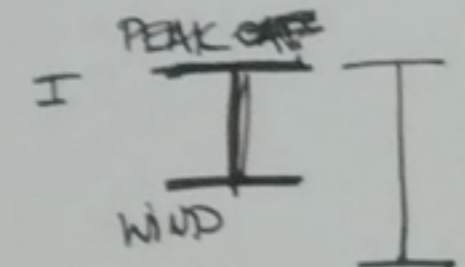

doc. collect meter

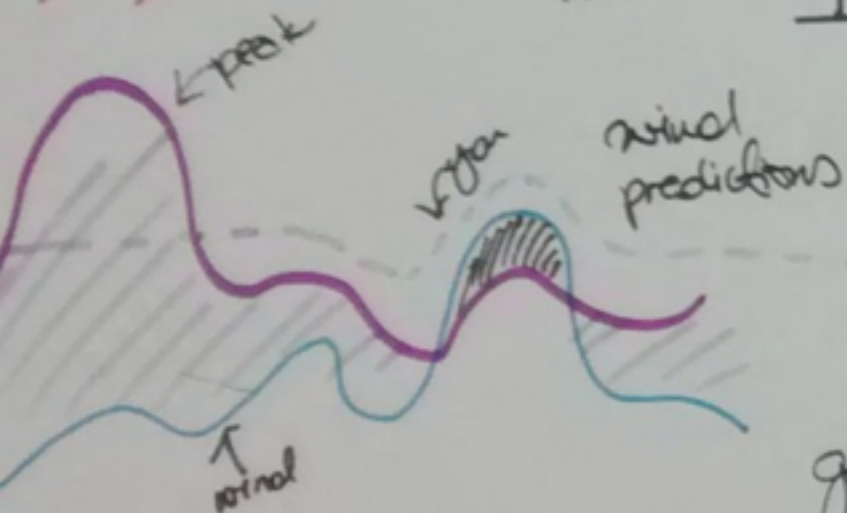

goal: shift peak to 2nd?
 reduce peak?
 reduce overall consumption?

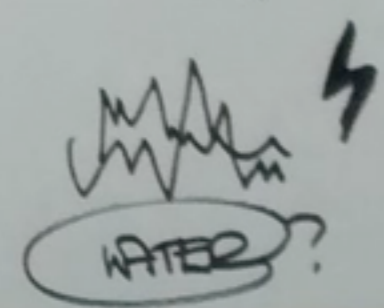

create infom v. salpaction

daily trigger

when to do

what works?

Spin igner

6m data

“I have become slightly obsessed by your energy graph and am very grateful that you have found a way to record the load and wind power generated in PEI. Do you by any chance have a spread sheet of these values? I am looking at using storage to balance wind fluctuations and was hoping to try and using the real load and wind data to accomplish that.”



Policy Leadership



Logistical Leadership

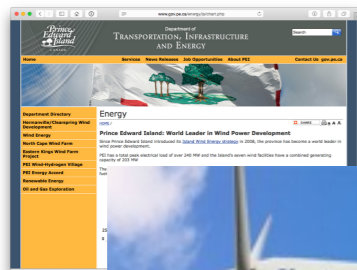

Partner Cooperation



Active Consumers

Open data is machine-readable data about and from the enterprise, provided in known, well-documented, digital formats, without restriction, to the general public.



Policy Leadership



Logistical Leadership

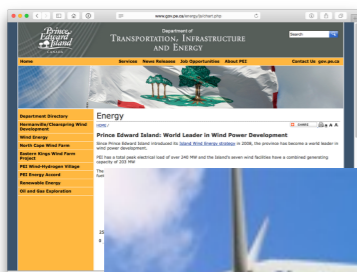

Partner Cooperation



Active Consumers



Policy Leadership



Logistical Leadership

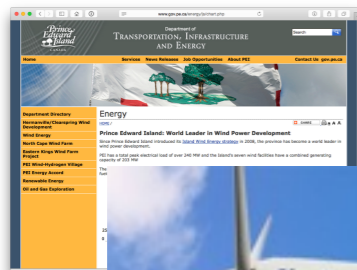

Partner Cooperation



Active Consumers

Open data is predicated on a belief that broadly and enthusiastically sharing data about and from the enterprise is both good public policy and good for the enterprise itself.

**You probably don't
believe that.**

**The institution certainly
doesn't believe that.**

**And that's your
open data challenge
in a nutshell.**



Go

Facilities Management

[Mission](#)

[Policies and Priorities](#)

[Parking Services](#)

[Maintenance Division](#)

[Security Division](#)

[Room Booking](#)

[Sustainability](#)

[Staff](#)

[Services](#)



Facilities Management

Facilities Management serves UPEI through the planning, design, construction, operation, protection, and maintenance of its physical facilities.

The department provides direction and support to senior administration in planning deferred maintenance, enhancement of buildings, and new capital investment in facilities.

Additionally, Facilities Management maintains a safe and inviting campus for all students, faculty, staff, and visitors through its Security Division; and, information about parking, emergency contacts, and campus cleaning.

[Submit a Maintenance Request or Work Order](#)

Live in UPEI Residence? [Submit a Residence Work Order](#)

Mission

Main Navigation

- [Home](#)
- ▼ [NEW!](#)
 - [School of Nursing / FNS Building Webcam](#)
- ▶ [Policies and Procedures](#)
- [Client Reception](#)
- [Directory](#)
- [Room Booking](#)
- [Maintenance Services](#)
- [Campus Closures or Delays](#)
- ▼ [Security Services](#)
 - [Emergencies](#)
 - [Forms & Policies](#)
 - [Lost and Found](#)
 - [Parking](#)
 - [Storm Procedures](#)
- [Campus Buildings & Floor Plans](#)
- [Map](#)
- ▶ [Service Standards](#)
- [Campus Aerial Photos](#)

The mission of the Facilities Management Department is to serve the University community through the planning, design, construction, operation, protection, and maintenance of its physical facilities, and to provide direction and support to senior administration in planning deferred maintenance, enhancement of buildings, and new capital investment in facilities.

These services support and enhance the academic, research, and administrative environment of the University.



UPEI Campus July 2006: Aerial Photo

Campus Buildings & Floor Plans

Main Navigation

- [Home](#)
- ▼ **NEW!**
 - [School of Nursing / FNS Building Webcam](#)
- ▶ [Policies and Procedures](#)
- [Client Reception](#)
- [Directory](#)
- [Room Booking](#)
- [Maintenance Services](#)
- [Campus Closures or Delays](#)
- ▼ [Security Services](#)
 - [Emergencies](#)
 - [Forms & Policies](#)
 - [Lost and Found](#)
 - [Parking](#)
 - [Safety Initiatives](#)
 - [Storm Procedures](#)
- [Campus Buildings & Floor Plans](#)
- [Campus Map](#)
- ▶ [Service Standards](#)
- [Campus Aerial Photos](#)



550 University Avenue
Charlottetown, PE
Canada C1A 4P3
upei.ca

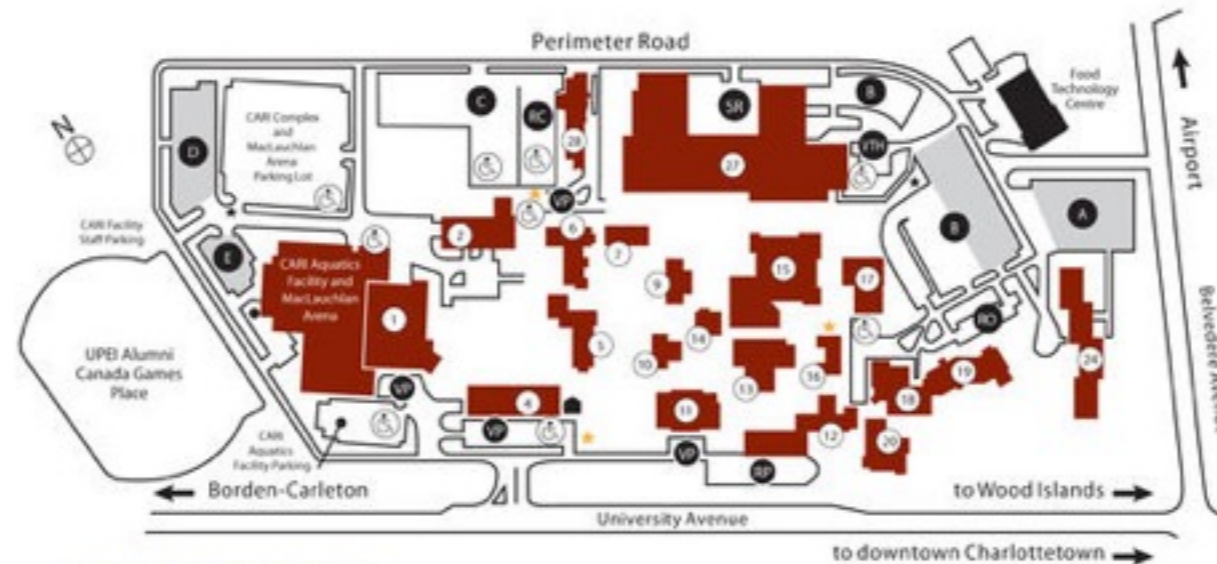

CAMPUS BUILDINGS

- | | | |
|-------------------------------------|---|---|
| 1. Chi-Wan Young Sports Centre (SC) | 11. Kelley Memorial Building (K) | 19. Bill and Denise Andrew Hall (Residence) |
| 2. Central Utility Building | 12. Don and Marion McDougall Hall (MCD) | 20. Bernardine Hall (Residence) |
| 4. W.A. Murphy Student Centre | 13. Duffy Science Centre (D) | 24. Blanchard Hall (Residence) |
| 5. Main Building (M) | 14. Chaplaincy Centre | 27. Atlantic Veterinary College (AVC) |
| 6. Steel Building (ST) | 15. Robertson Library (RL) | 28. Regis and Joan Duffy Research Centre |
| 7. Dalton Hall (DA) | 16. Campus Kids Child Care Centre | |
| 9. Memorial Hall (ME) | 17. K.C. Irving Chemistry Centre (KCI) | |
| 10. Cass Science Hall (CASS) | 18. Wanda Wyatt Dining Hall (DH) | |
- Reserved for Future Expansion - numbers 3, 8, 21, 22, 23, 25, 26, 29*

PARKING

- | | | |
|---|--|---|
| <ul style="list-style-type: none"> Ⓐ General parking & overnight parking during winter months Ⓑ General & Designated parking Ⓒ Designated parking Ⓓ General parking Ⓔ General parking □ General parking areas | <ul style="list-style-type: none"> ★ EMERGENCY CALL STATION Ⓥ Veterinary Teaching Hospital client parking ♿ Accessible parking Ⓡ Residences Only | <ul style="list-style-type: none"> ☼ WEATHER SHELTER Ⓜ Visitor metered parking Ⓡ Reserved parking Ⓢ Shipping and Receiving Ⓡ Research Centre parking |
|---|--|---|

- [CARI Aquatics Facility & MacLauchlan Arena](#)
- [Chi-Wan Young Sports Centre](#)
- [Central Utility Building](#)
- [W.A. Murphy Student Centre](#)
- [Main Building](#)
- [Steel Building](#)
- [Dalton Hall](#)
- [Memorial Hall](#)
- [Cass Science Hall](#)
- [Kelley Memorial Building](#)
- [Don and Marion McDougall Hall](#)
- [Duffy Science Centre](#)
- [Chaplaincy Centre](#)
- [Robertson Library](#)
- [Campus Kids Child Care Centre](#)
- [K.C. Irving Chemistry Centre](#)
- [Wanda Wyatt Dining Hall](#)
- [Bill and Denise Andrew Hall](#)
- [Bernardine Hall](#)
- [Blanchard Hall](#)
- [Atlantic Veterinary College](#)
- [Regis and Joan Duffy Research Centre](#)
- [PEI Food Technology Centre](#)

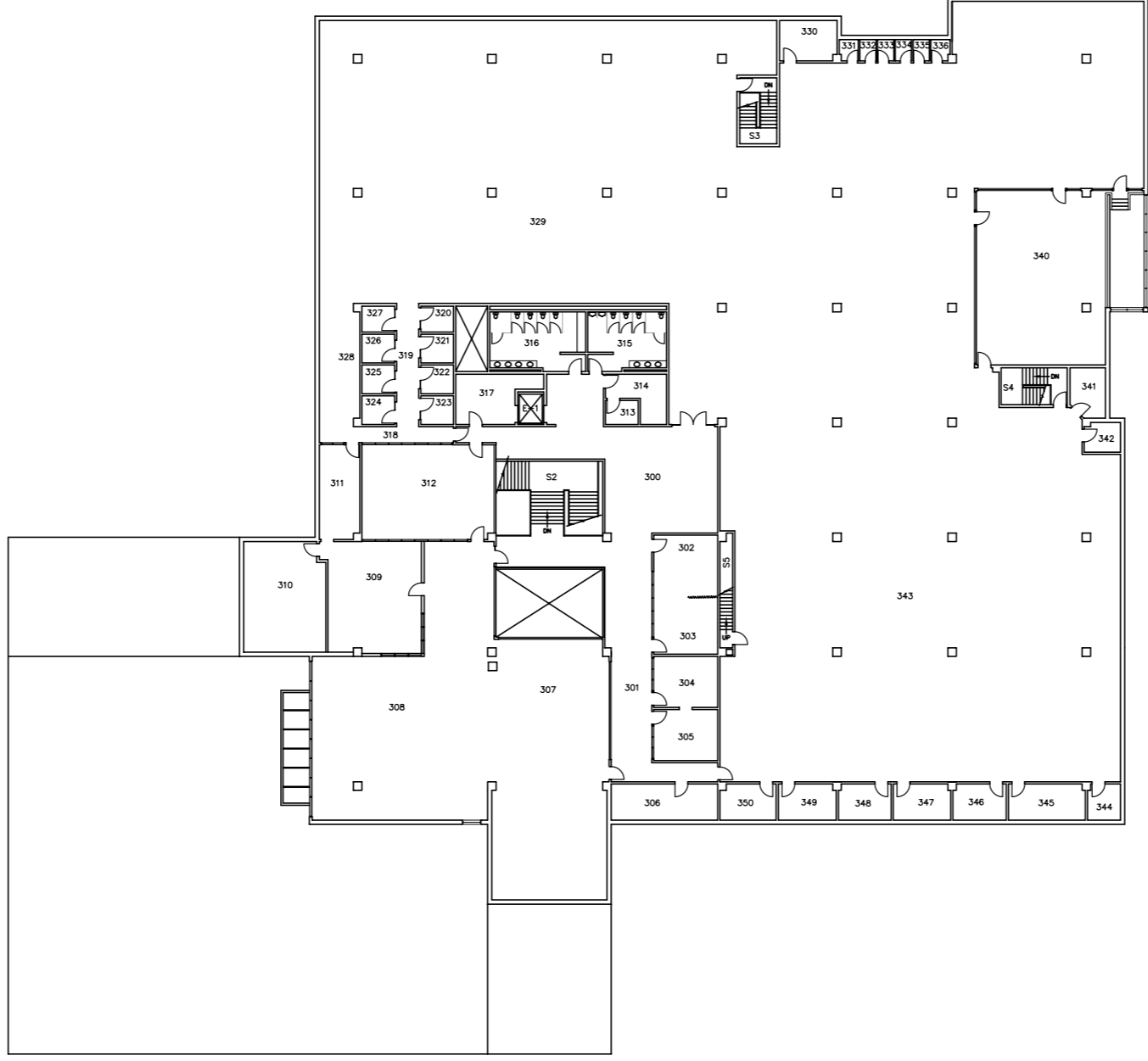

University of Prince
Edward Island

550 University Avenue
Charlottetown, PE
C1A 4P3

www.upei.ca

BUILDING: ROBERTSON LIBRARY

LEVEL: 3

DATE: SEPT. 2005

SCALE: 1/32" = 1'-0"

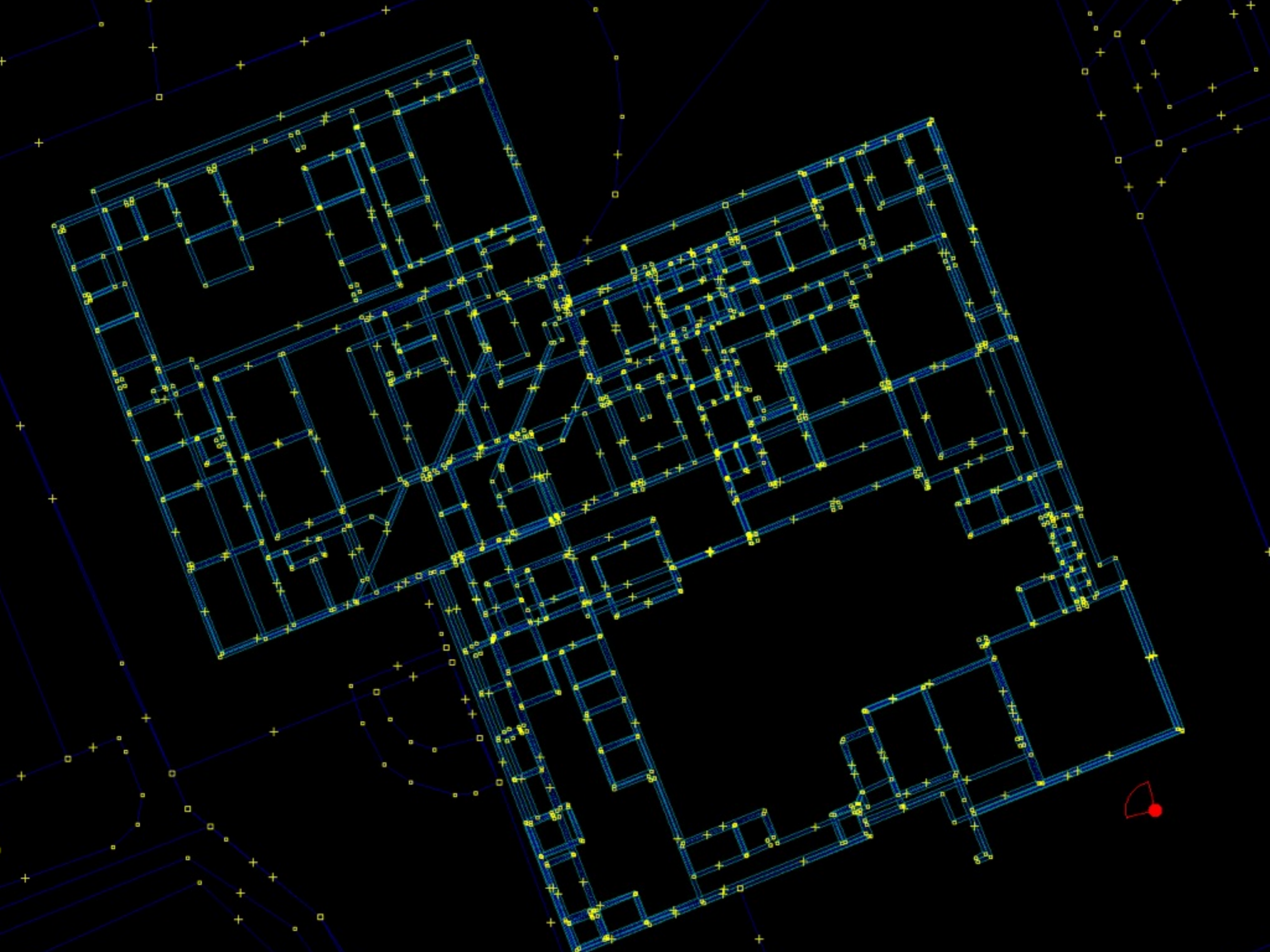



Baker Plaza

Memorial Hall

Cass Science Hall

Chaplaincy Centre

Gazebo

Kelley Memorial Building

Service Corridor

Duffy Science Centre

Robertson Library

Service Corridor

Paddock

Gener and Design

Teaching Hospital Client Parking

Service Corridor

Campus Kids Childcare Centre

K.C. Irving Chemistry Centre

P

General and Designated

Bio | Food | Tech Parking

University Avenue

Bernardine Hall

Wanda Wyatt Dining Hall

Bill and Denise Andrew Hall

Bio | Food | Tech

Residence Only

General and Overnight

Blanchard Hall

Belvedere Avenue

Dawson Court

35
39
43
51
55
59
63
68
64
60
58
56
52



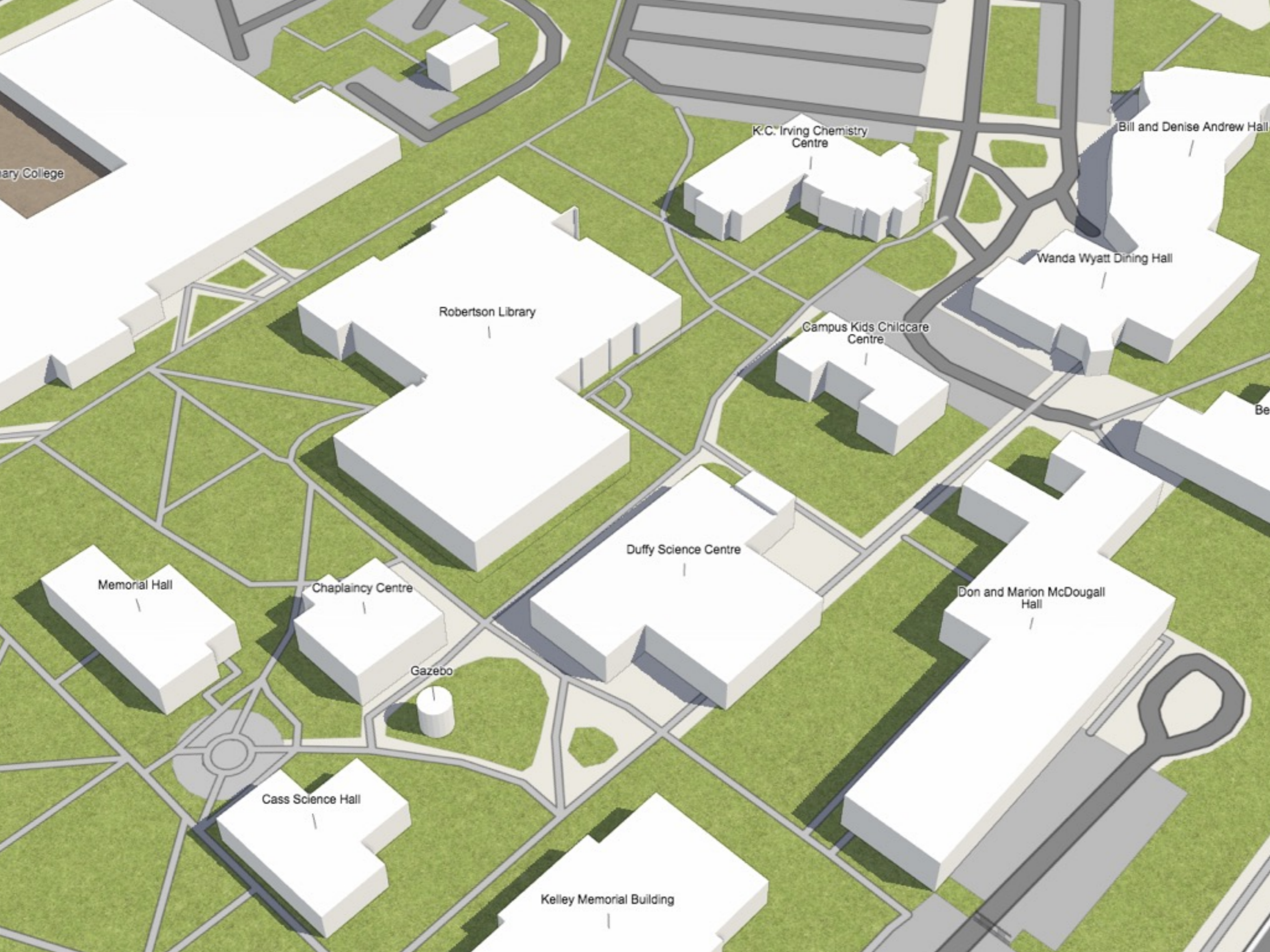

ary College

K.C. Irving Chemistry Centre

Bill and Denise Andrew Hall

Robertson Library

Wanda Wyatt Dining Hall

Campus Kids Childcare Centre

Be

Memorial Hall

Chaplaincy Centre

Duffy Science Centre

Don and Marion McDougall Hall

Gazebo

Cass Science Hall

Kelley Memorial Building

Consider that, 1000x over...

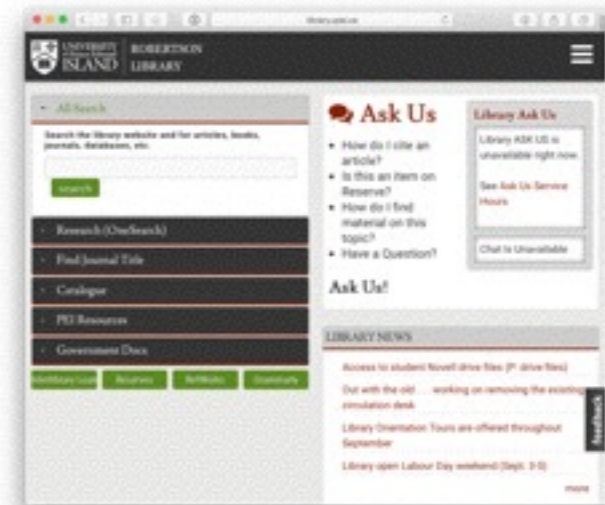
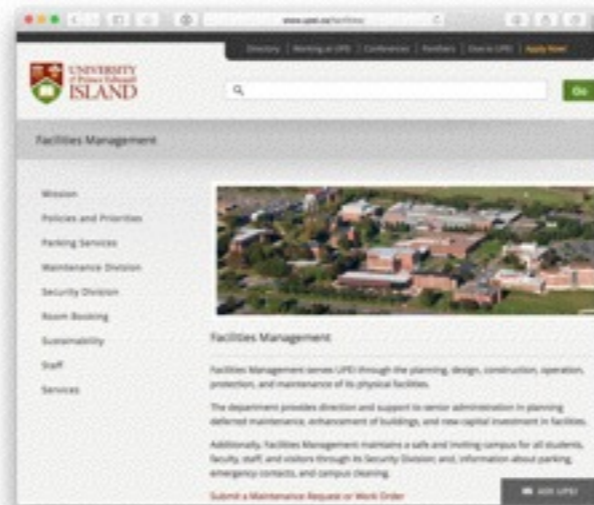
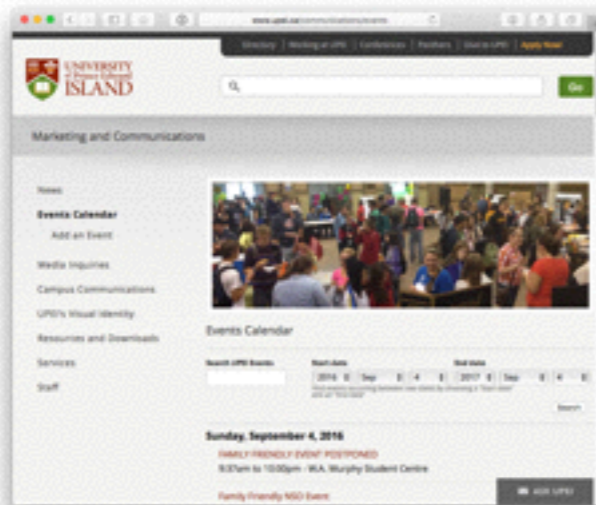
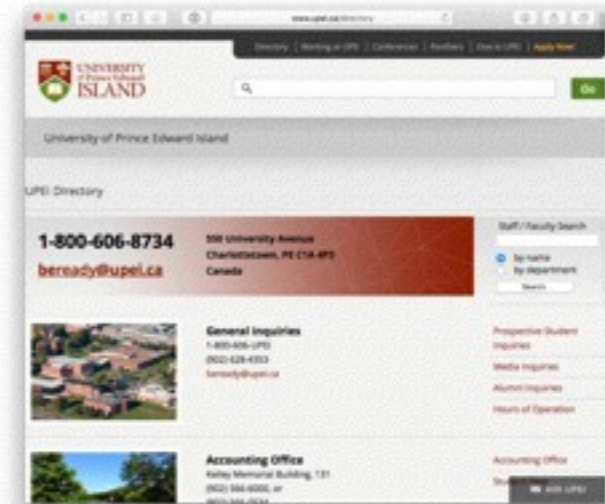
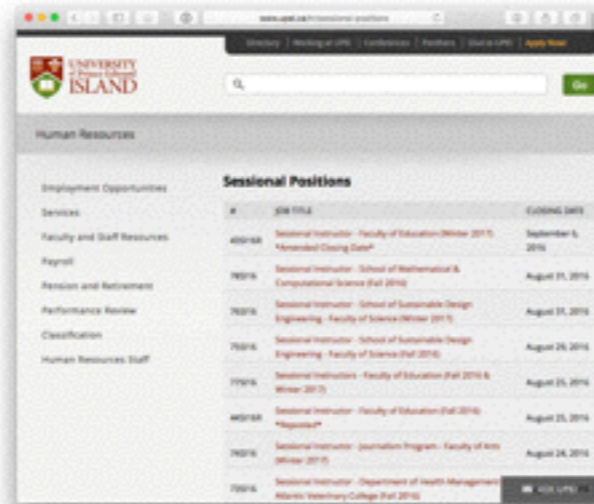

open data = good for the enterprise

Open data is predicated on a belief that broadly and enthusiastically sharing data about and from the enterprise is both good public policy and good for the enterprise itself.

To get there...

**Are we prepared to
believe this is true?**

open data = good for the enterprise

**How will we
communicate this
within and beyond the
institution?**

open data = good for the enterprise

**How will we build this
into the DNA of the
institution?**

open data = good for the enterprise



Open data is predicated on a belief that broadly and enthusiastically sharing data about and from the enterprise is both good public policy and good for the enterprise itself.

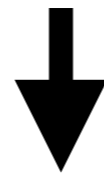

Open data is machine-readable data about and from the enterprise, provided in known, well-documented, digital formats, without restriction, to the general public.



Slides are online at

1.ruk.ca/upeibog-slides



These slides are released under a Creative Commons license.
You are encouraged to distribute them as far and as
wide as possible under the terms of the license.